



## Metal Building Design in RISA

By Debbie Penko, P. E.

October 16, 2014

# METAL BUILDINGS

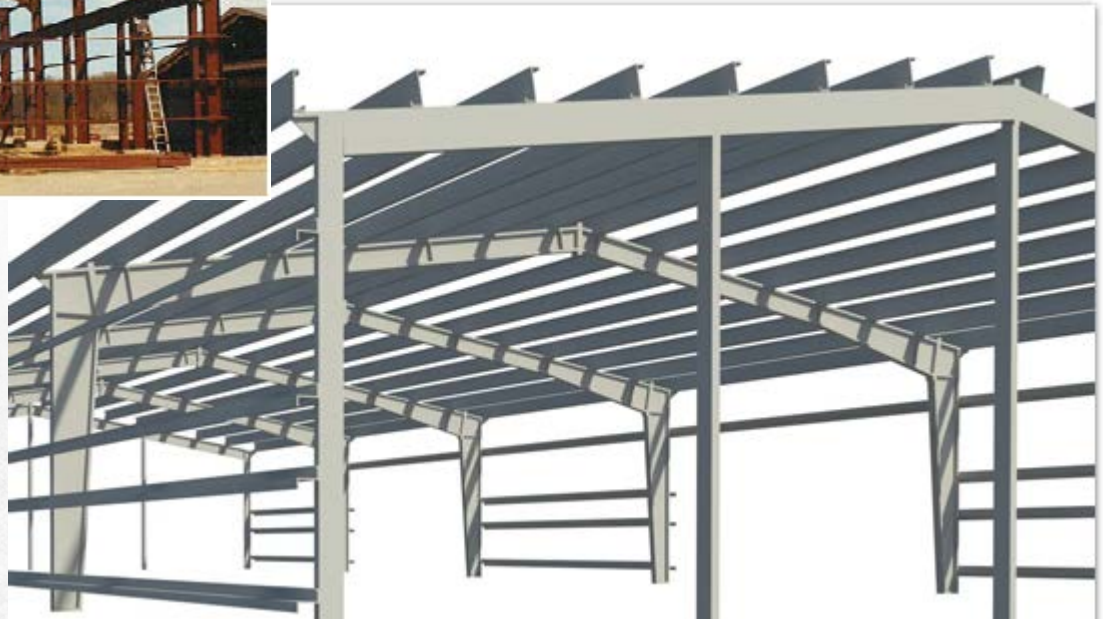

# MODELING CONSIDERATIONS

- Multi-Material model
- Tapered Wide Flanges
- How to Model Bracing? Cable Braces, Purlins, Girts
- Connections
- Foundations

# LET'S MODEL!

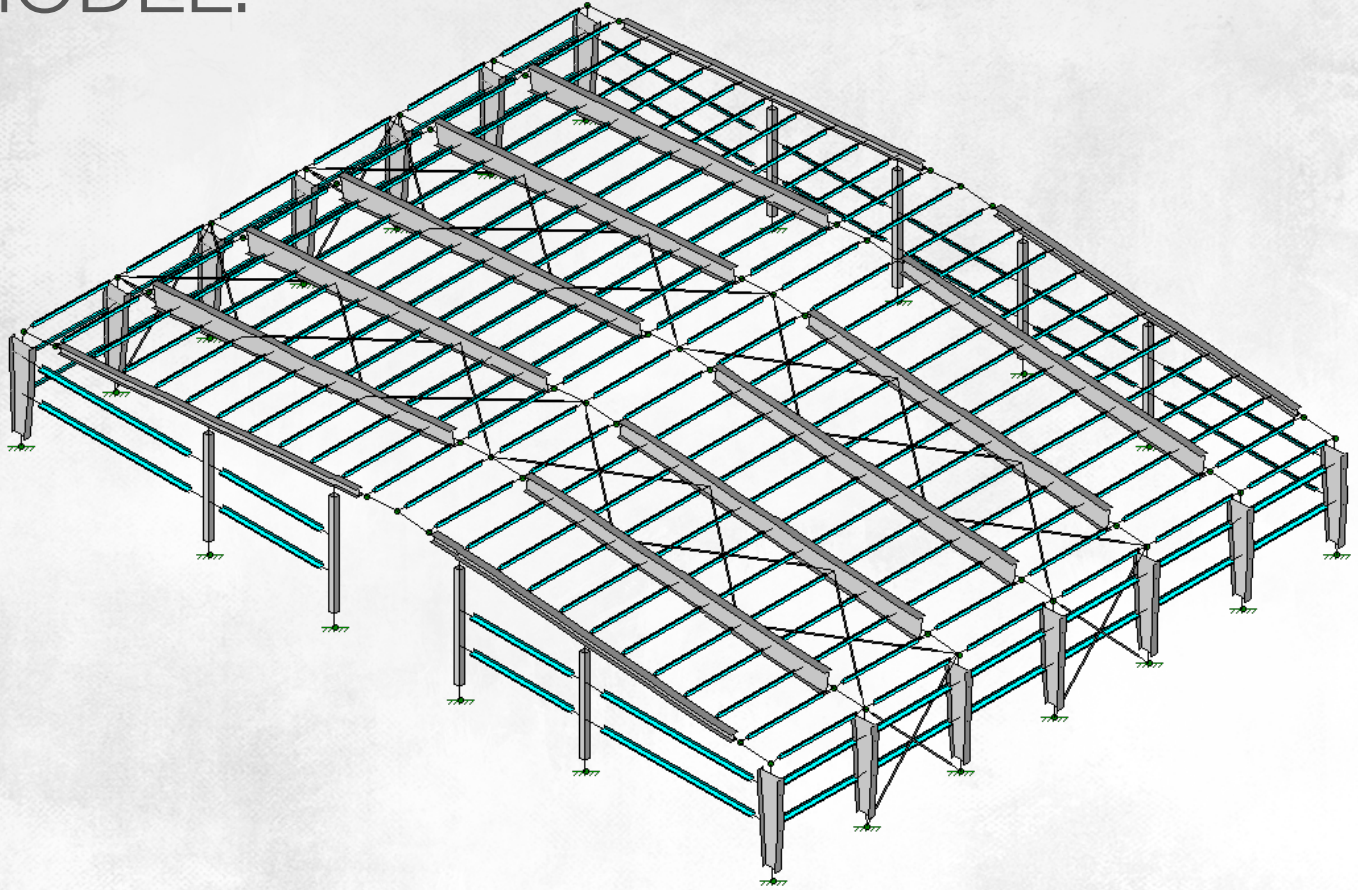

# ROTATE SLOPING MEMBERS

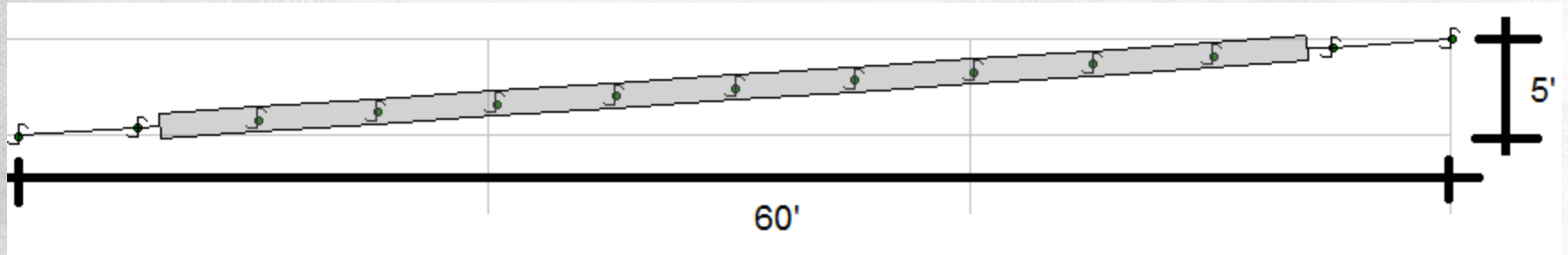

Tangent = rise/run → 4.76 degrees

# QUESTIONS?

We'll be available for another few minutes to answer questions.

Or email [info@risa.com](mailto:info@risa.com)

RISA Website: [www.risa.com](http://www.risa.com)

RISA Articles: [www.risanews.com](http://www.risanews.com)

The logo for RISA Technologies features the word "RISA" in a large, bold, blue sans-serif font with a slight gradient. To the left of "RISA" are three vertical blue bars of varying heights, resembling a bar chart. Below "RISA" is the word "TECHNOLOGIES" in a smaller, black, all-caps sans-serif font. A registered trademark symbol (®) is located to the upper right of the letter "A" in "RISA".

**RISA**<sup>®</sup>  
**TECHNOLOGIES**

Debbie Penko, P.E. | [debbiep@risa.com](mailto:debbiep@risa.com)

[risa.com](http://risa.com)